

Choose your Disc Blade / Elija su Disco

Plain and Notched Disc Blades / Discos lisos y dentados

Diameter	8"	9"	10"	11"	12"	13"	14"	16"	18"	20"	22"	24"	26"	28"	30"	32"	34"	36"
Thickness	203 mm	229 mm	255 mm	280 mm	305 mm	330 mm	355 mm	405 mm	455 mm	510 mm	560 mm	610 mm	660 mm	710 mm	760 mm	810 mm	860 mm	915 mm
3,00 mm	X	X	X	X	X	X	X	X	X	X								
3,50 mm						X	X	X	X	X								
4,00 mm							X	X	X	X	X							
4,50 mm								X	X	X	X	X						
4,75 mm								X	X	X	X	X	X					
5,00 mm								X	X	X	X	X	X	X				
6,00 mm								X	X	X	X	X	X	X	X			
7,50 mm											X	X	X	X	X			
8,00 mm											X	X	X	X	X	X		
9,00 mm											X	X	X	X	X	X	X	X
10,00 mm														X	X	X	X	X
12,00 mm															X	X	X	X

Please contact us about different sizes / Favor consultarnos para diferente tamaños

Flat Disc Blades / Discos planos

Diameter	10"	11"	12"	13"	14"	15"	16"	18"	20"	22"	24"	26"	28"	30"
Thickness	255 mm	280 mm	305 mm	330 mm	355 mm	381 mm	405 mm	455 mm	510 mm	560 mm	610 mm	660 mm	710 mm	760 mm
3,00 mm	X	X	X	X	X	X	X							
3,50 mm		X	X	X	X	X	X	X						
4,00 mm		X	X	X	X	X	X	X	X	X				
4,50 mm			X	X	X	X	X	X	X	X	X			
4,75 mm			X	X	X	X	X	X	X	X	X	X		
5,00 mm			X	X	X	X	X	X	X	X	X	X		
6,00 mm			X	X	X	X	X	X	X	X	X	X	X	X
7,50 mm										X	X	X	X	
8,00 mm											X	X	X	X
9,00 mm												X	X	X
10,00 mm														X

Please contact us about different sizes / Favor consultarnos para diferente tamaños

Wavy / Ripple / Fluted / Corrugated Disc Blades / Discos ondulados / rañurados / corrugados

Diameter	10"	11"	12"	13"	14"	15"	16"	18"	20"	22"
Thickness	255 mm	280 mm	305 mm	330 mm	355 mm	381 mm	405 mm	455 mm	510 mm	560 mm
3,00 mm	X	X	X	X						
3,50 mm		X	X	X	X	X	X			
4,00 mm		X	X	X	X	X	X	X	X	
4,50 mm					X	X	X	X	X	
4,75 mm						X	X	X	X	X
5,00 mm								X	X	X
6,00 mm								X	X	X

Please contact us about different sizes / Favor consultarnos para diferente tamaños



AGRICULTOR

Standard sharpening for harrow and plow discs / Ángulos de filo padronizados para disco de rastra y de arado

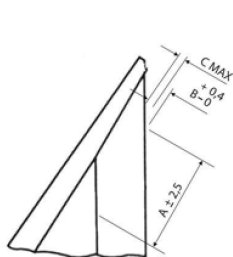

INTERNAL / FILO INTERNO

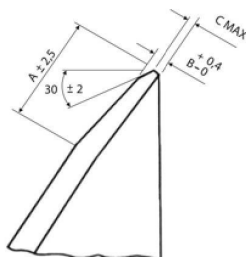

EXTERNAL / FILO EXTERNO

Thickness Espesor	A	B	C
3,00 mm	12	2,0	0,5
3,50 mm	15	2,0	0,5
4,00 mm	20	2,2	0,8
4,50 mm	23	2,5	0,8
4,75 mm	23	2,5	0,8
5,00 mm	23	2,5	0,8
6,00 mm	26	3,0	0,8
7,50 mm	29	4,0	1,0
8,00 mm	29	4,0	1,0
9,00 mm	32	4,5	1,0
10,00 mm	32	4,5	1,0
12,00 mm	38	5,5	1,2

Coulter sharpening / Ángulos de filo del disco de arado

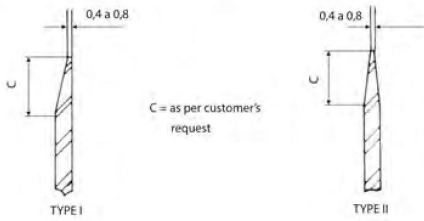

Standard notches / Muestras padronizadas

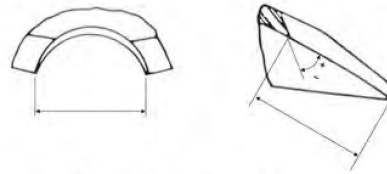

Disc Diameter	mm		inch	
	A	B	A	B
8" a 22"	70	35	2,49 / 64	1,25 / 64
24" a 28"	82	41	3,15 / 64	1,5 / 8
30" a 36"	95	47,5	3,3 / 4	1,7 / 8

Holes for plow discs / Diámetro de los agujeros

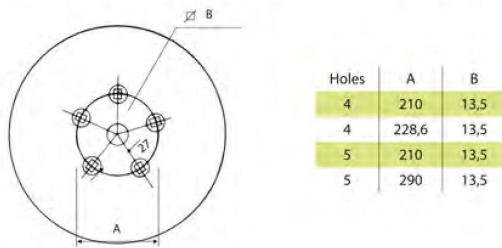

Ripple coulter / Discos planos corrugados

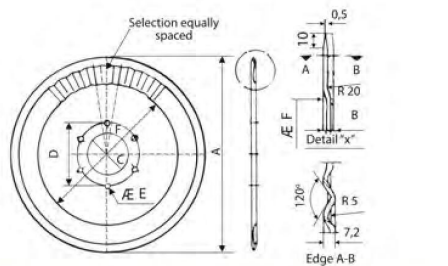

Æ A	B	Æ C	Æ D	Æ E	F	Section Quantity
406	4,25	80	116	6 holes Æ 8,5	290	50
406	4,25	60	88	4 holes Æ 8	290	50
406	3,96	80,3	115	5 holes Æ 11	290	50
356	3,25	60	88	4 holes Æ 8	260	38
356	3,25	80	115	6 holes Æ 8,5	260	38

Conical discs (notched or plain) / Discos Cónicos (dentado y liso)

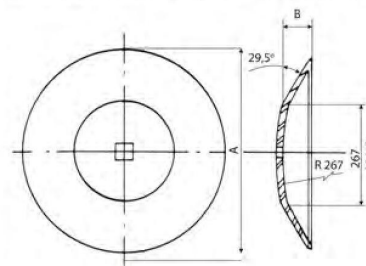

A (diameter)		B	
mm	inch	mm	inch
510	20	79	3,1/8
560	22	92	3,5/8
610	24	108	4,1/4
660	26	122	4,13/16

Wavy coulter / Discos planos ondulados

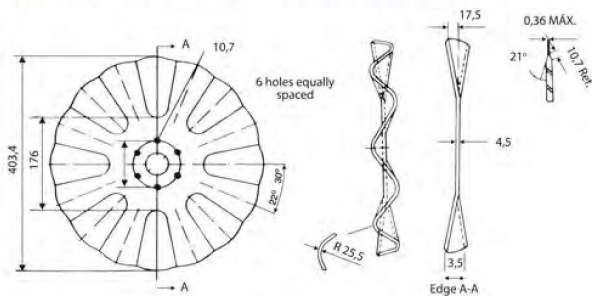

Discs with dimples / Disco con tetones

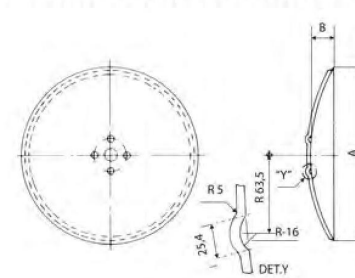

A		B	
mm	inch	mm	inch
660	26	108	4,17/64
710	28	104	4,7/64
760	30	120	4,47/64
810	32	125	4,59/64
860	34	134	5,9/32
912	36	137	5,13/32

Bubble coultter / Discos planos estriados

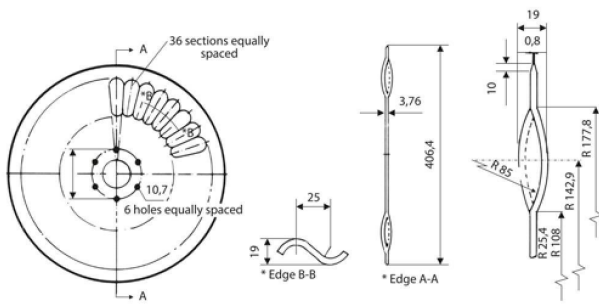

Flat Back Disc / Discos Planos

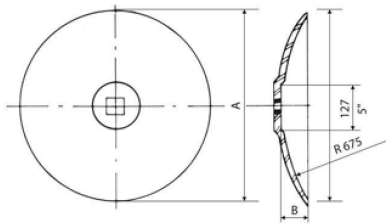

(Plain or notched)

A		B	
mm	inch	mm	inch
510	20	51	2
560	22	63,5	2,1/2
610	24	76,2	3
660	26	88,9	3,1/2



Plain or notched discs / Discos lisos o dentados

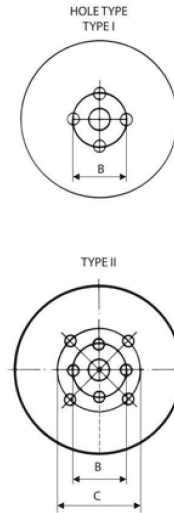

Type	Holes	Standard Size (mm)	DIA B	DIA C
I	3	Æ 8,5	55	-
I	3	Æ 7,5	62	-
I	3	Æ 8,4	70	-
I	4	Æ 8	70	-
I	6	Æ 6,3	73,2	-
I	5	Æ 7	77	-
I	5	Æ 8,5	80	-
I	4	Æ 11,1	82	-
I	3	Æ 9,5	86	-
I	4	Æ 8	88	-
I	6	Æ 6,5	90	-
I	4	Æ 12	94	-
I	4	Æ 9,5	95	-
I	3	Æ 10	95	-
I	6	Æ 6,8	96	-
I	6	Æ 8,5	100	-
I	4	Æ 10,5	101,6	-
I	6	Æ 9	105	-
I	4	Æ 11,5	111	-
I	6	Æ 8,5	115	-
I	4	Æ 13,5	120	-
I	4	Æ 11,1	141,4	-
I	6	Æ 6	164	-
I	6	Æ 14	175	-
I	4	Æ 17,5	251	-
I	4	Æ 19	253	-
I	6	Æ 14,2	265	-
I	4	Æ 13,5	292	-
I	4	Æ 14	292	-
I	8	Æ 11,5	292	-
II	4	Æ 10,5	110	150
II	4	Æ 13,5	150	224
II	5	Æ 11,5	140	275
II	4	Æ 13,5	146,8	208
II	3	Æ 11,1	175	250
II	4	Æ 14	124	244

Sizes and types of center holes / Tamaños y formas de agujero central

Round / Redondo

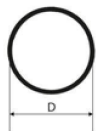

D		D		D	
mm	inch	mm	inch	mm	inch
16	5/8	40	1,37/64	66	2,19/32
19	3/4	41,2	1,5/8	70,6	2,25/32
25,4	1	43	1,11/16	76	3
26,5	1,1/16	46	1,13/16	77,5	3,3/64
28	1,7/64	48,4	1,29/32	79	3,7/64
28,6	1,1/8	49,0	1,15/16	80	3,5/32
30	1,3/16	50,0	1,31/32	88	3,15/32
31,75	1,1/4	51,0	2	90,5	3,9/16
33,3	1,5/16	54	2,1/8	92	3,5/8
34,9	1,3/8	56	2,13/64	110	4,21/64
36,5	1,7/16	60	2,23/64	120	4,27/32
38,5	1,33/64	61	2,13/32	121,4	4,25/32
39,0	1,17/32	62	2,7/16	124	4,7/8
39,7	1,9/16	64	2,33/64	155	6,7/64

Double square / Cuadrado doble

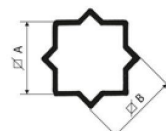

mm		inch	
A	B	A	B
23,2	26,2	29/32	1,1/16
26,5	29,5	1,1/16	1,13/16
26,5	32,5	1,1/16	1,5/16
32,5	39,0	1,5/16	1,17/32
29,5	32,5	1,3/16	1,5/16

Key shape / Forma de llave

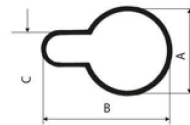

mm			inch		
A	B	C	A	B	C
60	85	19	2,23/64	2,53/64	3/4
55	70	15,8	2,11/64	2,3/4	5/8
65	76,2	14,3			

Square / Cuadrado

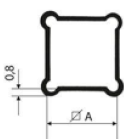

A		A	
mm	inch	mm	inch
19	3/4	38,1	1,1/2
25,4	1	39	1,17/32
26,5	1,1/16	40	1,37/64
30	1,3/16	43	1,11/16
31,75	1,1/4	46	1,13/16
32,5	1,5/16		

Square round / Redondo Cuadrado

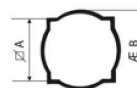

mm		inch	
A	B	A	B
23,2	26,5	29/32	1,1/16
30,2	34,2	1,3/16	1,11/32
33,3	39,7	1,5/16	1,9/16
39,7	46	1,9/16	1,13/16

Hexagonal / Hexagonal



A	
mm	inch
88,9	3,1/2

Drilling star-shaped / Perforación estrella



A	
mm	inch
44,4	1,3/4